



17-965
16-1/2" FLOOR MODEL
DRILL PRESS

DP-4D-3

PART NO. 900610

Revised: 11/1/02

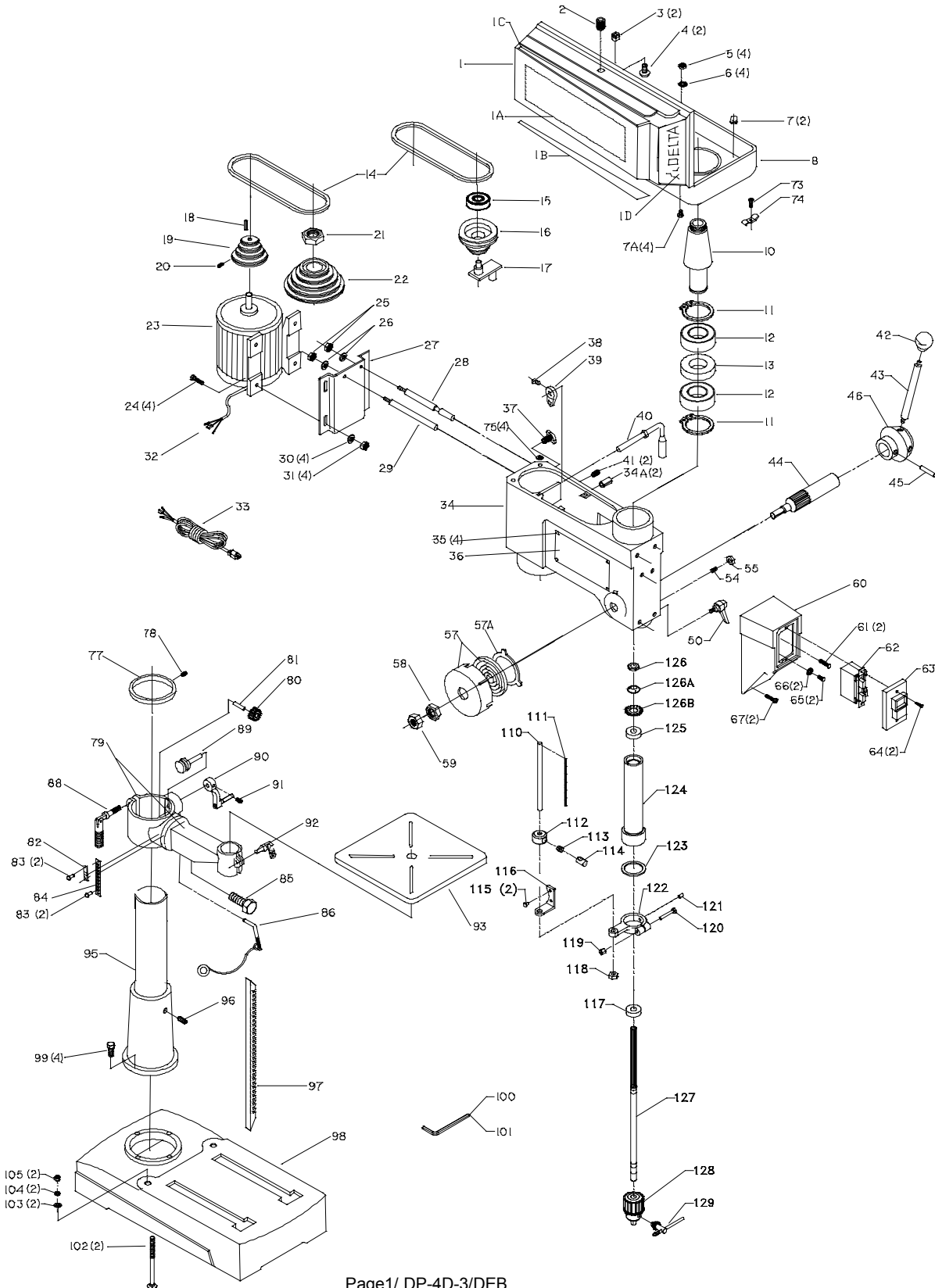

REPLACEMENT PARTS

Ref.	No.	Part No.	Description	Ref.	No.	Part No.	Description
	1	901169	UPPER PULLEY COVER (NOTE A), T2	58	902-01-020-1227		1/2-20 JAM NUT
		1311076	UPPER PULLEY COVER (NOTE A), T1	59	902-01-020-1227		1/2-20 JAM NUT
1A		901193	SPEED CHART, T2	60	1346235		SWITCH BOX
		1346225	SPEED CHART, T1	61	1246001		M5 X 12MM CHEESE HD SCREW
1B		1346222	NAMEPLATE (LEFT)	62	1340095		SWITCH
1C		1346223	NAMEPLATE (RIGHT)	63	1340100		SWITCH COVER ASSY
1D		901338	NAMEPLATE (FRONT), T2	64	1347694		M4.2 X 25MM PAN HD SCREW
		1346221	NAMEPLATE (FRONT), T1	65	1310143		M5 X 8MM PAN HD SCREW
2		1310065	KNOB	66	1320101		M5.3 EXT TOOTH WASHER
3		1310057	STRAIN RELIEF	67	1344641		M5 X 25MM CHEESE HD SCREW
4		1310547	M4.2 12MM PAN HD SCREW	73	1342455		M5 X 10MM PAN HD SCREW, T2
5		1243569	M4 HEX NUT, T2	74	1340719		CLAMP, T2
		1246002	M6 X 12MM CHEESE HD SCREW, T1	75	1343304		1/4" RUBBER WASHER, T2
6		1320102	M4.3 EXT TOOTH WASHER, T2	77	901168		RING, T2
		1310062	M6.4 FLAT WASHER, T1		1312009		RING, T1
7		1310056	GROMMET	78	1243339		M6 X 8MM HEX SOC SET SCREW
7A		1243501	M4 X 10MM CHEESE HD SCREW, T2	79	901187		TABLE BRACKET ASSY, INCL., T2
8		901189	L/PULLEY COVER W/HINGES (NOTE A), T2		1310079		TABLE BRACKET ASSY, INCL., T1
		1340705	L/PULLEY COVER W/HINGES (NOTE A), T1	80	1311007		PINION GEAR
10		1346228	SLEEVE	81	1311008		SHAFT
11		1311060	RETAINING RING	82	1311016		INDICATOR
12		920-04-010-7266	BALL BEARING	83	1310016		5MM DRIVE SCREW
13		1311059	SPACER	84	901176		SCALE, T2
14		1346231	V-BELT (A27)		1311015		SCALE, T1
15		1312028	BALL BEARING	85	1311012		BOLT
16		1346232	PULLEY	86	1346077		LOCK PIN W/CABLE
17		1312029	SHAFT	88	1311017		HANDLE
18		1311071	KEY	89	1311009		WORM GEAR
19		1312024	PULLEY	90	1344257		HANDLE ASSY
20		1330200	M8 X 12MM HEX SOC SET SCREW	91	1243321		M6 X 10MM HEX SOC SET SCREW
21		1311061	NUT	92	1311018		HANDLE W/STUD
22		1346233	PULLEY	93	901186		TABLE, T2
23	n	908973	MOTOR	93	1346236		TABLE, T1
24		1246034	M8 X 20MM HEX HD SCREW	95	901340		COLUMN ASSY, T2
25		1243476	M12 HEX NUT		1310595		COLUMN ASSY, INCL., T1
26		904-02-020-1705	1/2" LOCK WASHER	96	1311003		M10 X 12MM HEX SOC SET SCREW
27		1311029	BRACKET	97	1312008		RACK
28		1312012	ROD	98	1312001		BASE
29		1312031	ROD	99	1246029		M10 X 40MM HEX HD SCREW
30		1243526	M8.4 FLAT WASHER	100	428-06-101-0002		3MM HEX WRENCH
31		1243398	M8 HEX NUT	101	432-07-101-0004		5MM HEX WRENCH
32		1340706	MOTOR CORD	102	1344329		M8 X 125MM CARRIAGE HD SCREW
33		1340707	POWER CORD	103	1243526		M8.4 FLAT WASHER
34		901190	HEAD BODY, T2	104	1246157		M8.1 LOCK WASHER
		1346242	HEAD BODY, T1	105	1243398		M8 HEX NUT
34A		1246110	M6 X 24MM SPRING PIN	110	1346043		STOP ROD
35		1310016	5MM DRIVE SCREW	111	901197		SCALE, T2
36		900417	WARNING LABEL, T2		1346044		SCALE, T1
		1346224	WARNING LABEL, T1	112	1346045		STOP NUT ASSY, INCL:
37		901171	LOCK SCREW, T2	113	1346046		SPRING
		1311028	LOCK SCREW, T1	114	1346047		RELEASE
38		1310105	M8 X 16MM HEX HD SCREW	115	1246155		M6 X 12MM FLAT HD SCREW
39		1311026	ECCENTRIC	116	1346237		MOUNTING BRACKET
40		1312011	HANDLE	117	920-04-020-5335		BALL BEARING
41		1311003	M10 X 12MM HEX SOC SET SCREW	118	1343492		M12 LOCK NUT
42		1346024	BALL KNOB	119	1346049		CLAMP NUT
43		1346025	HANDLE	120	1346205		M6 X 45MM HEX HD SCREW
44		1340708	PINION ASSY, INCL:	121	1243303		M6 X 12MM HEX SOC SET SCREW
45		1330410	M5 X 20MM SPRING PIN	122	901191		STOP COLLAR, T2
46		1346026	HUB		1346238		STOP COLLAR, T1
50		901192	HANDLE, T2	123	1311051		RUBBER WASHER
		1346234	HANDLE, T1	124	1346239		QUILL
54		1311048	SPECIAL SCR	125	920-04-020-5335		BALL BEARING
55		1243496	M10 HEX NUT	126	1311056		NUT
57		1310082	SPRING ASSEMBLY	126A	1311055		RING
				126B	1311054		M17.5 FLAT WASHER
				127	1346241		SPINDLE ASSY
				128	1312022		5/8" CHUCK, INCL:
				129	1313105		CHUCK KEY

NOTE A: HARDWARE REQUIRED TO ASSEMBLE UPPER ANED LOWER PULLEY COVERS.

- (4) 1243501 MR X 10MM SLOT CHEESE HD SCREW
- (4) 1243525 M4.1 LOCK WASHER
- (4) 1243569 M4 HEX NUT

STANDARD SAFETY EQUIPMENT

In order to promote tool safety, Delta Machinery strictly enforces the policy of repairing or replacing any damaged or missing standard safety equipment on machines presented to Delta Authorized Service Centers for service/repairs. Any product that is presented to a Delta Authorized Service Centers for repairs which contains missing or damaged standard safety equipment will have that equipment repaired or replaced and the customer will be charged for any such service/repairs. Customers can avoid such charges only if the missing safety component is supplied to the

This parts list is provided to aid in obtaining service parts. Copies of the instruction and maintenance literature can be obtained through the Delta Technical Publications Department or through your service outlet.